

VITRINEMEDIA



RE/MAX R-60 INSTALLATION GUIDE

STEP 1 – DETERMINE WHERE YOU WANT TO HANG THE PANEL



STEP 2 – SECURE THE POWER RAIL TO THE SURFACE

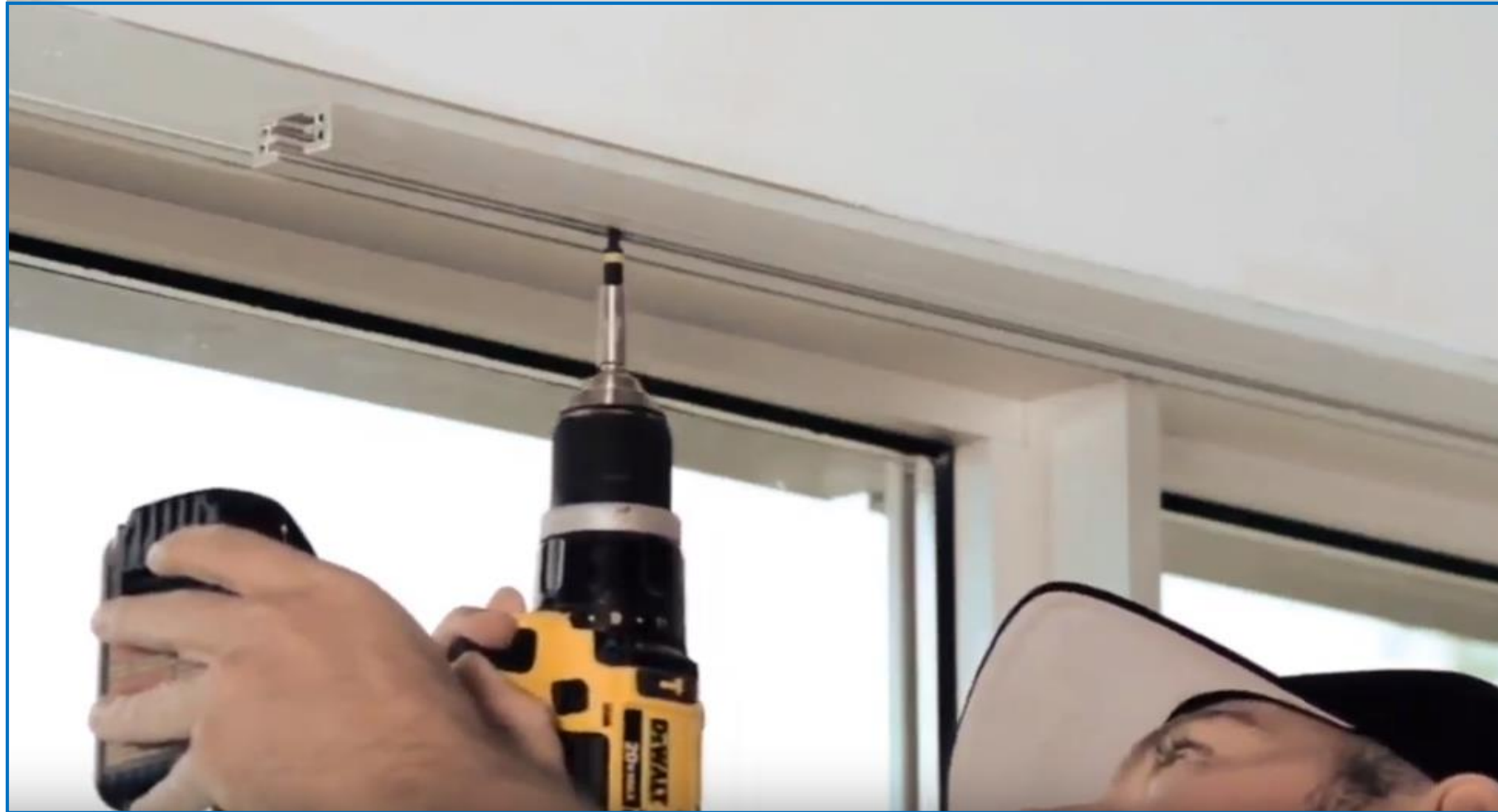

STEP 3 – INSERT THE WIRE CABLES INTO THE FIXTURE SETS



Press the screw cap inwards to feed the cable through.



Join the two elements together and tighten

Do not tighten at this stage. If it is closed, one can't feed the cable through or adjust the height of the panel. Tighten once the panel has been hung.

STEP 4 – ATTACH THE FIXTURE SETS TO THE POWER RAIL

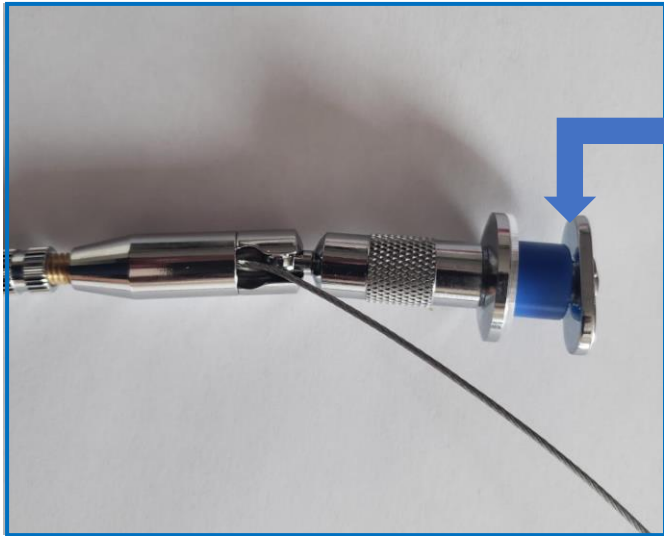

Turn plate fully counter-clockwise



Insert fixture sets into power rail and tighten clockwise.

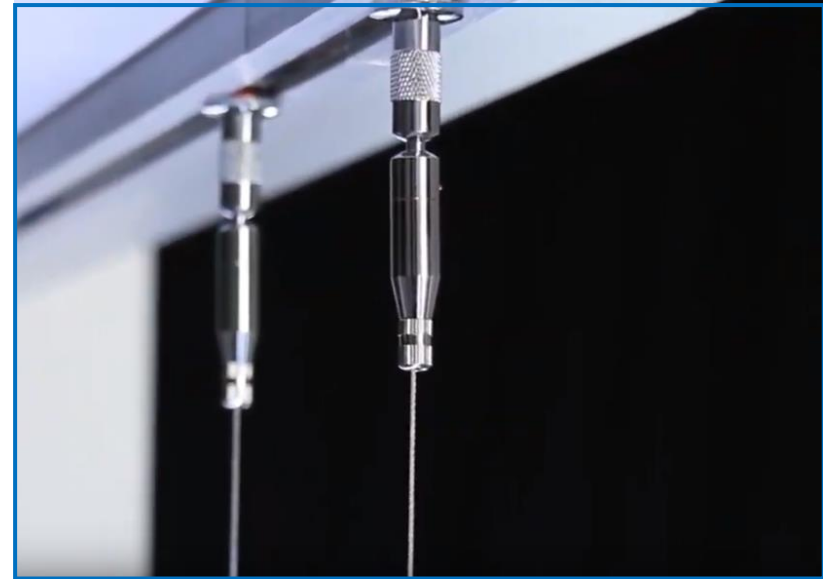

Blue one on the right, red one on the left

STEP 5 – HANG THE PANEL

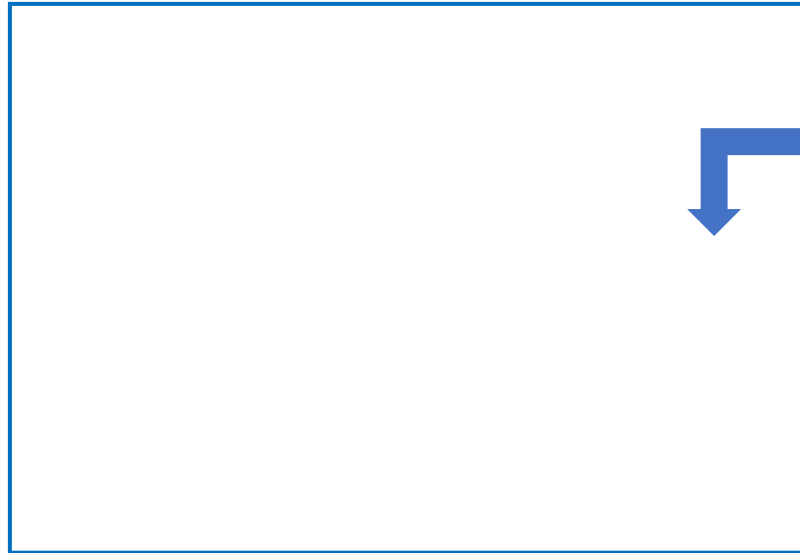

Insert the cable balls into the slots in the panel

Adjust the cables to your desired length

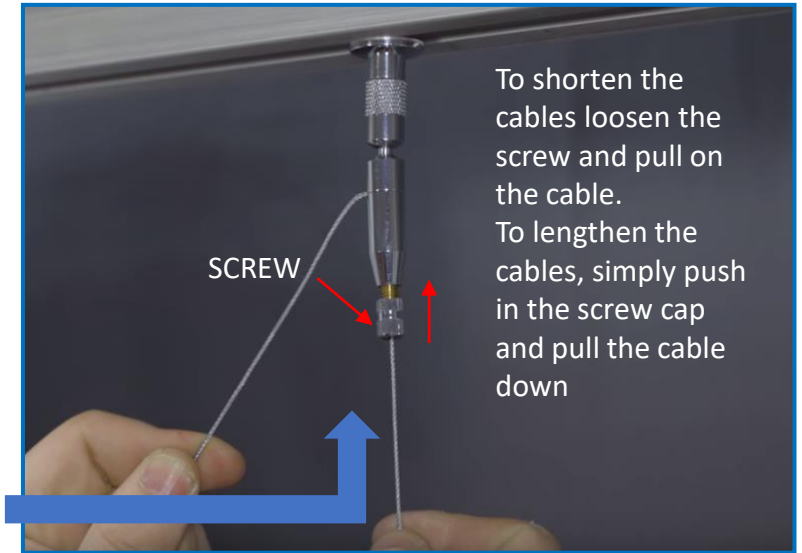

SCREW

To shorten the cables loosen the screw and pull on the cable.
To lengthen the cables, simply push in the screw cap and pull the cable down

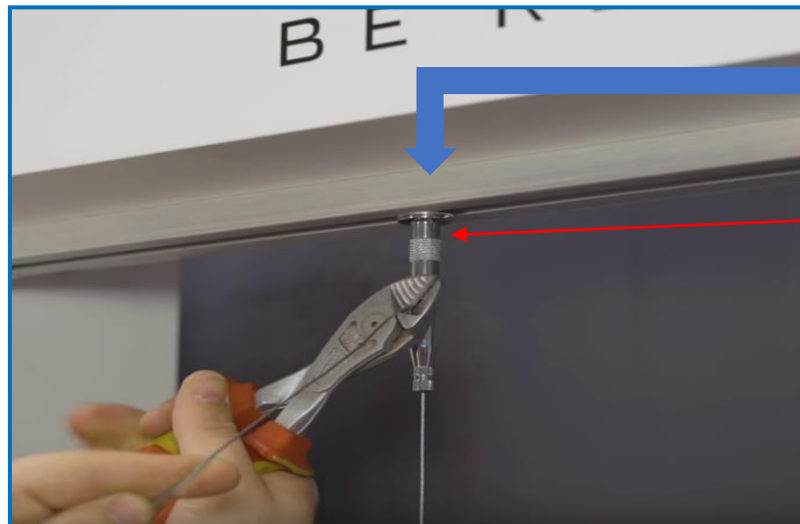

Trim off the excess cable
Make sure the fixture set is tight into the rail

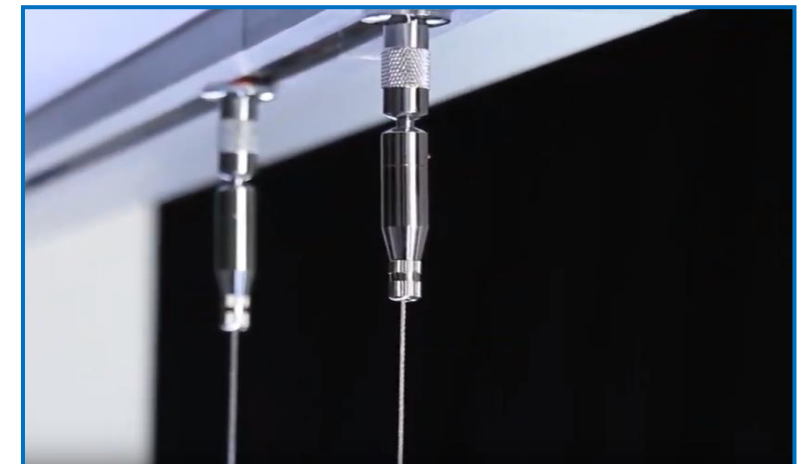

STEP 6 – CONNECTING THE POWER

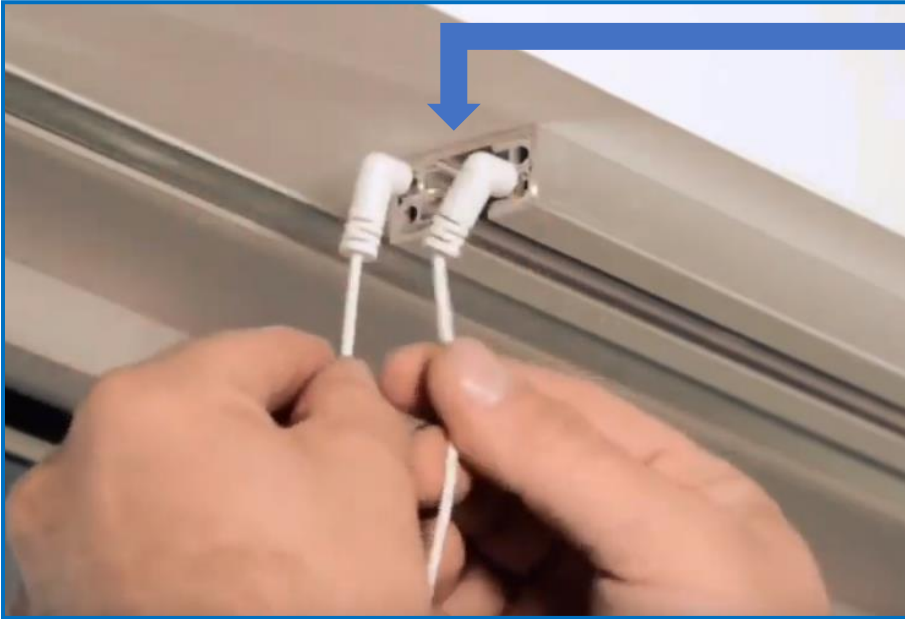

Insert the two white plugs into the end of the power rail.

They should be inserted diagonally, not in parallel.



OR



Connect the white power cord to the transformer and switch on!

BE REMARKABLE